

REV.	EN. NO.	DESCRIPTION	SIGN	DATE
C1	N/A	INITIAL DRAWING	Liu	2019/08/13

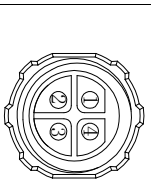
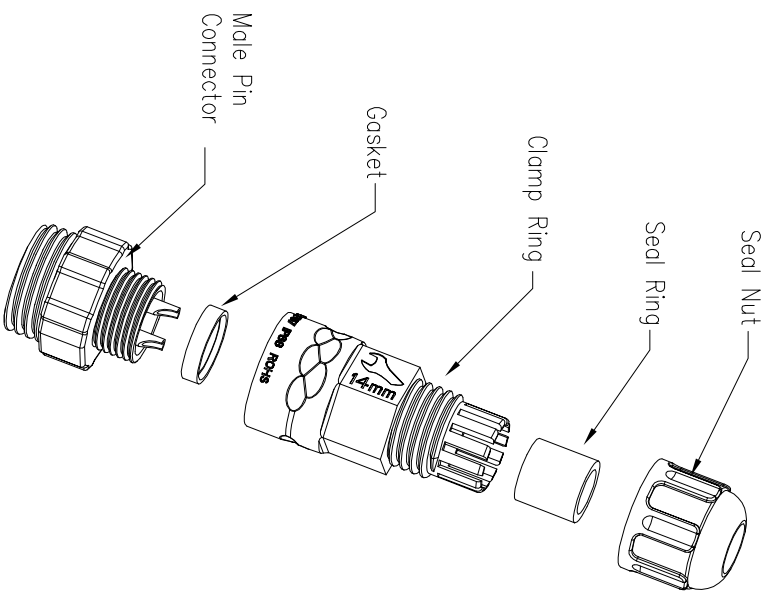
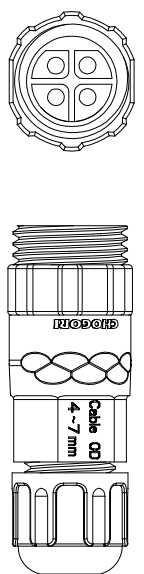
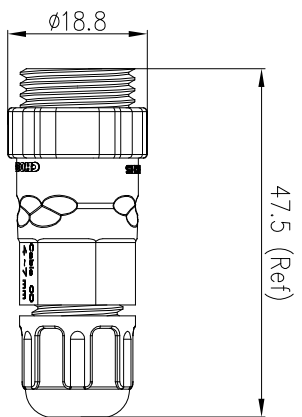

Pin Number

22XXX311-01

4 Pin
P/N: 22004311-01
Pin Assignments
Front View

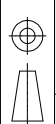

UNIT: mm
TOLERANCE
X ±0.25
.XX ±0.15
.XXX ±0.05
ANGLES ±1°

DESCRIPTION

Standard Series Screw
Female Plug With Male Pin

SCALE: 1:1
REV: C1
SIZE: A4
SHEET: 1 OF 1
* : Inspection Item

CHOGORI

PART NO 22XXX311-01

DRAWN BY Liu

DATE 2019/08/13

DWG NO

CHECKED BY Mo

DATE 2019/08/13

CUSTOMER

APPROVED BY Panson

DATE 2019/08/13

- Specification:
- 1.Operation Temperature: -45°C~105°C.
 - 2.Insulation Resistance: 100MΩ at DC500V.
 - 3.Contact Resistance: <10mΩ
 - 4.Withstand Voltage: 1500V AC
 - 5.Operating Current: 10A
 - 6.Operating Voltage: AC 125V
 7. Waterproof Rate: IP67 (Mated)
 - 8.Seal Nut: Nylon, Black
 - 9.Seal Ring: Silicon, Black.
 - 10.Clamp Ring: Nylon, Black
 - 11.Gasket: Silicon, Red
 - 12.Male Pin: Copper Alloy, Gold Plated
 - 13.Connector: Nylon+GF, Black
 - 14.RoHS Compliant.
 - 15.UL Compliant.
 - 16.Cable Range OD: φ3.5mm~φ6.8mm
 - 17.Mating Cap: 806-00060-01