

REV.	EN. NO.	DESCRIPTION	SIGN	DATE
C1	N/A	INITIAL DRAWING	Liu	2019/08/13

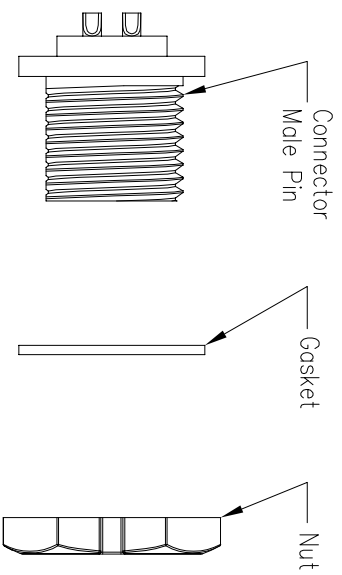

22XXXX515-01

Pin Number

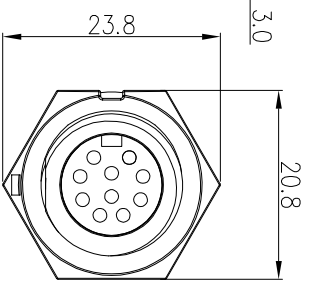
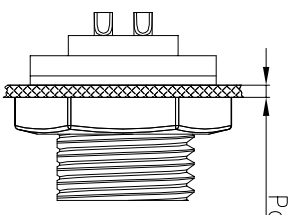
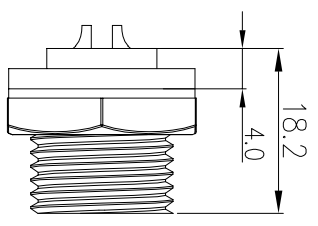
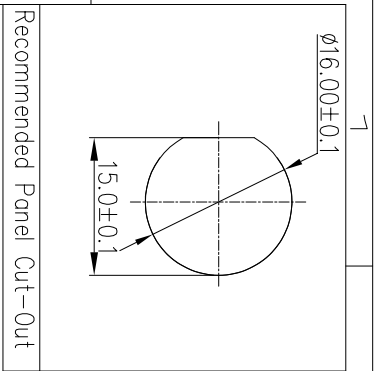
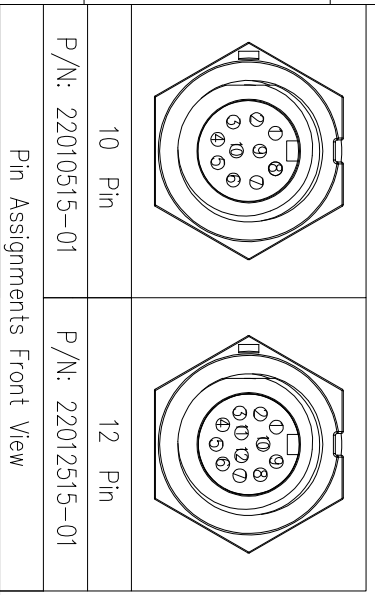

Pin Assignments Front View

DESCRIPTION
Standard Series Screw
Front Mount With Male Pin

UNIT: mm	SCALE: 1:1	SHEET: 1	OF: 1
TOLERANCE .X .XX .XXX ANGLES	±0.25 ±0.15 ±0.05 ±1°	REV: C1	SIZE: A4

- Specification:
1. Operation Temperature: -45°C~105°C.
 2. Insulation Resistance: 100MΩ at DC500V.
 3. Contact Resistance: <math><10\text{m}\Omega</math>
 4. Withstand Voltage: 1000V AC
 5. Operating Current: 2A
 6. Operating Voltage: AC 30V
 7. Waterproof Rate: IP67 (Mated)
 8. Housing: Nylon, Black
 9. Male Pin: Copper Alloy, Gold Plated
 10. Gasket: Silicon Gray
 11. Panel Nut: Nylon, Black
 12. RoHS Compliant.
 13. Mating Cap P/N: 806-00030-00

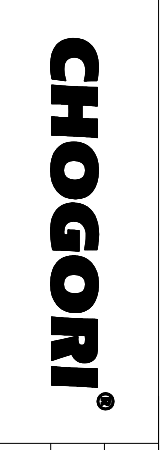

PART NO	22XXXX515-01	DRAWN BY	Liu	DATE	2019/08/13
DWG NO		CHECKED BY	Mo	DATE	2019/08/13
CUSTOMER		APPROVED BY	Ponson	DATE	2019/08/13