

MP20502 2-Wire Mini-Belt Pack Instruction Manual

Revision History

Revision	Release Date	Revisions	Issued By	Approved By
1.0	4/24/23	Production Release	KP	JAB

Inspired Energy 25440 NW 8th Place, Newberry, FL 32669
US toll free: 1-888-5-INSPIRE (1-888-546-7747) Tel: 352 472 4855 Fax: 352 472 4859

www.inspired-energy.com

MPL20502



Curly 2-Wire Mini-Belt Pack Instructions for use

Adapter Overview:

The MP20502 is a mini-belt pack that facilitates the voltage passthrough of a “ND205x” series battery pack via a curly 2-wire output cable.

What’s in the box?

1. One MP20502 Curly 2-Wire Mini-Belt Pack

Safety:

1. Do not expose the device to water or liquids.
2. Do not open the case, no user serviceable parts are inside.
3. Avoid shorting.
4. Never use a modified or damaged battery or adapter.
5. Do not attempt to charge batteries while in the device.
6. Caution - during use the adapter connector(s) and may become warm.

Using your Adapter:

Ensure the Mini-Belt Pack is away from sources of heat and moisture, and insert your Inspired Energy “ND205x” series battery pack.

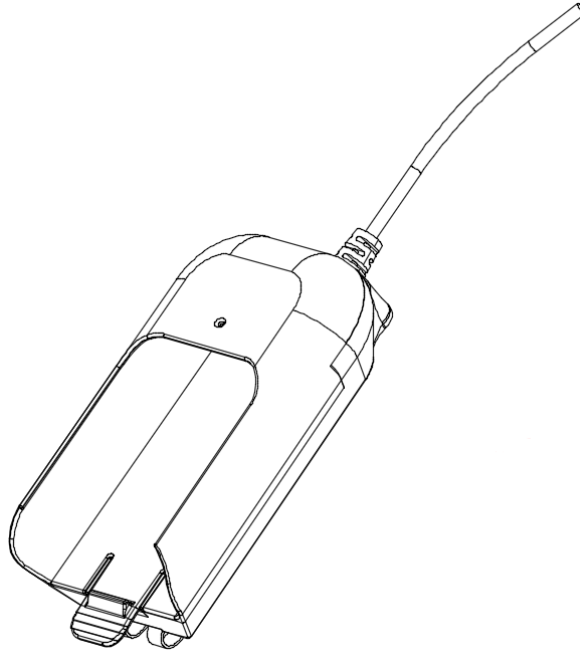

Output Power:

As a pass-through design, the voltage of the installed battery pack is connected the output cable of the MP20502. The Belt-Pack is limited to the power output of the installed “ND205x” series battery pack. If there is no battery pack installed, or the battery is fully discharged, there will be no output on the cable. For more information on the output power limitations of your battery pack, please refer to the battery specification datasheet available on our website: www.inspired-energy.com.

Compatibility:

The MP20502 is fully compatible with all Inspired Energy® brand “ND205x” Series standard and custom battery packs. For a full list of all compatible Inspired Energy batteries, please visit:

www.inspired-energy.com

MP20502 Specification Summary

Weight:	0.141kg / 4.96oz
Height:	36.83mm / 1.45"
Length:	118.87mm / 4.68"
Width:	82.30mm / 3.24"
Communications Complies:	System Management Bus Rev 1.1, Smart Battery Data Specification Rev 1.1 and Smart Battery Charger Specification Rev 1.1 compliant
Power Source:	Inspired Energy "ND205x" series battery pack

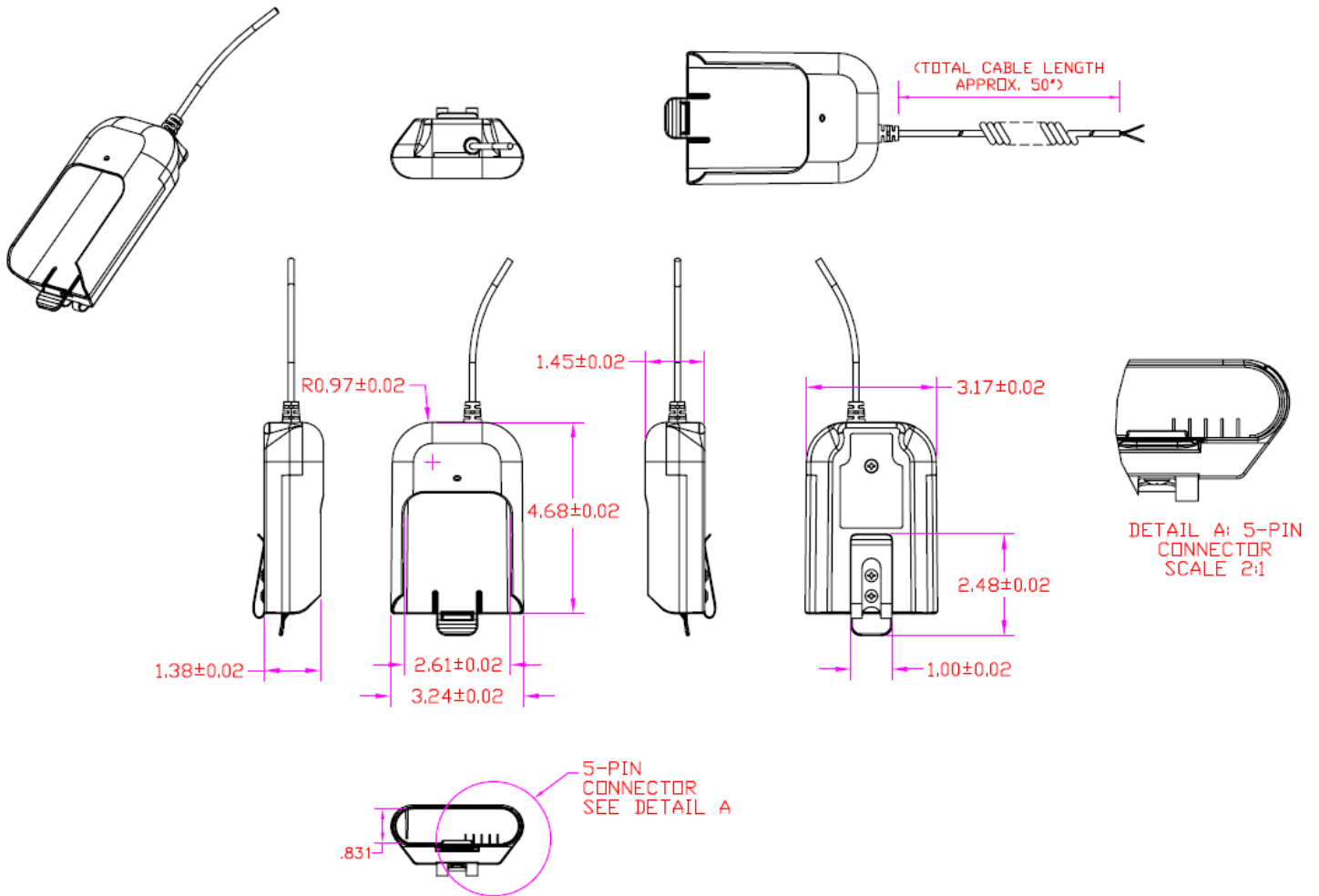

Note: Dimensions are in inches.
DC Jack not available for this model.