



REED SWITCH DEVELOPMENTS CORP.

2524 Norwood Court
Racine, WI 53403
Ph: (262)883-9060

sales@reedswitchdevelopments.com

SPECIFICATION SHEET

2053-4109-000

Alternate Part Numbers:
AM2053-4109-00-01
3730-2053-4109-000-ND

Active / Equivalent Part Numbers:

2053-4109-000 - Magnetic Actuator Only

AM2053-4109-00-01 - Magnetic Actuator Only

3730-2053-4109-000-ND - Magnetic Actuator Only

2052 Series Magnetic Reed Switch Actuator

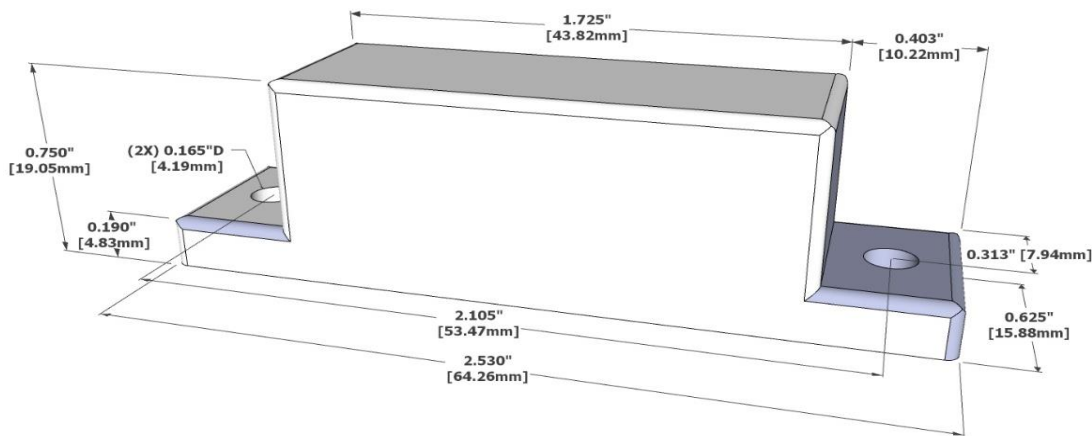

All measurements are in inches [millimeters]

| Specifications | Description | UM |
|------------------------------|--------------------------------|--------|
| Shape | Rectangular with Mounting Tabs | |
| Length | 2.530"/64.26mm | in/mm |
| Width | 0.625"/15.88mm | in/mm |
| Height | 0.750"/19.05mm | in/mm |
| Housing Material | Celanex 3316 | |
| Magnetic Orientation | Through Length | |
| Max Operating Temperature | 975/525 | °F/°C |
| Curie Temperature | 1580/860 | °F/°C |
| BR max | 12.8 | kGauss |
| BH max | 5.5 | MGOe |
| Coercive Force Hc | 640 | kOe |
| Intrinsic Coercive Force Hci | 640 | kOe |

Assembly Certifications

| | |
|------------------------|---|
| RoHS / REACH Compliant | Y |
| Conflict Free Material | Y |

REV DATE: 04/20/2023

DISCLAIMER NOTICE: INFORMATION FURNISHED IS PROPRIETARY, AND IS BELIEVED TO BE ACCURATE AND RELIABLE, AND IS SUBJECT TO CHANGE WITHOUT NOTICE. IT SHALL BE THE RESPONSIBILITY OF THE BUYER TO ENSURE THAT THE GOODS ARE SUFFICIENT AND SUITABLE FOR THE PURPOSE OR PURPOSES INTENDED (WHETHER BY THE BUYER OR BY ANY THIRD PARTY) AND THAT THEIR CAPACITY AND PERFORMANCE IS NOT ADVERSELY AFFECTED BY ANY ITEMS USED IN THEIR INSTALLATION (WHERE RELEVANT) AND/OR IN CONNECTION WITH THEM.

WBE Certified - State of Wisconsin - MFR CAGE CODE: 32604

www.reedswitchdevelopments.com